



Heartland Ag
Group Ltd.

Farmland For Sale

Jesse Schmid Farm Tract #4

68.60 Acres
Top Quality Farmland

Texas Township
DeWitt County, Illinois

Tract #4 of the Jesse Schmid Farms is located 1 mile southeast of Clinton. The soils include Catlin, Sable and Ipava with a productivity index of 133.9. Details on the farm are in this brochure. *Don't miss this investment opportunity.* Heartland Ag Group Ltd. signs mark the property.

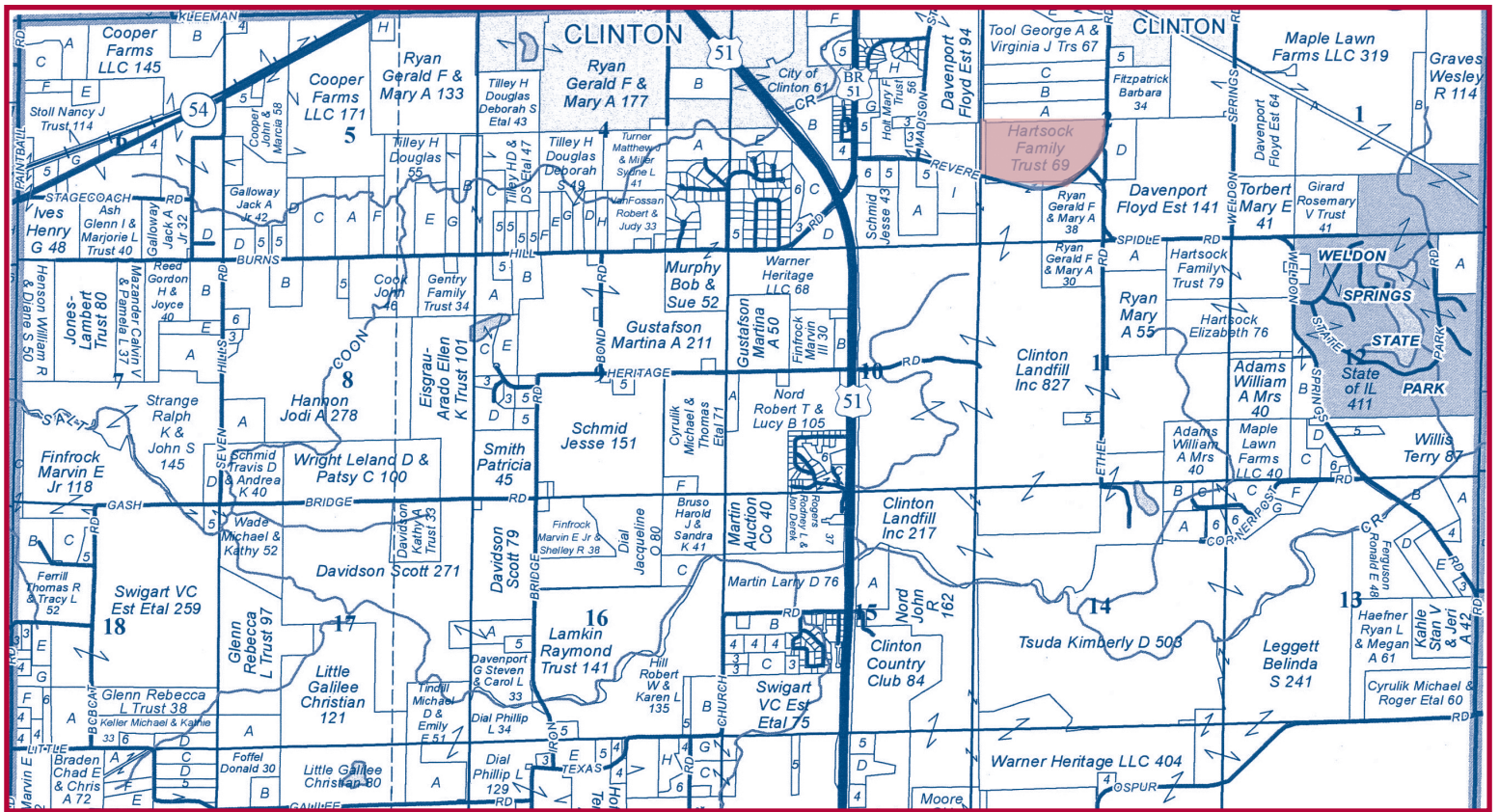

Reprinted with permission of Rockford Map Inc.

▼ Location

Tract #4 of the Jesse Schmid Farms is located 1 mile east of Clinton. Public access to the property is provided by Revere Road which forms the south and east boundary. **Our Heartland Ag Group Ltd. signs mark the property.**

▼ Legal Description

The complete legal description on this property is found in a title commitment that will be made available upon request.

Parcel ID #12-02-300-006 (68.60 acres)

This land is all located in Section Two (2), Township Nineteen North (T19N), Range Two East (R2E), of the Third Principal Meridian (3rd PM) in Texas Township, DeWitt County, Illinois.

▼ Aerial Photograph



Aerial photograph was provided by the AgriData, Inc.

▼ FSA Data

The following information was provided by the DeWitt County Farm Service Agency (FSA) office in Clinton, Illinois:

Farm No.	784
Tract No.	1294
Tillable Acres	69.90
Corn Base Acres	35.0
PLC Corn Yield	159
Soybean Base Acres	34.9
PLC Soybean Yield	50

Note - The DeWitt County FSA office has verified that there are no highly erodible acreage or wetlands identified on this property.

▼ Soil Map

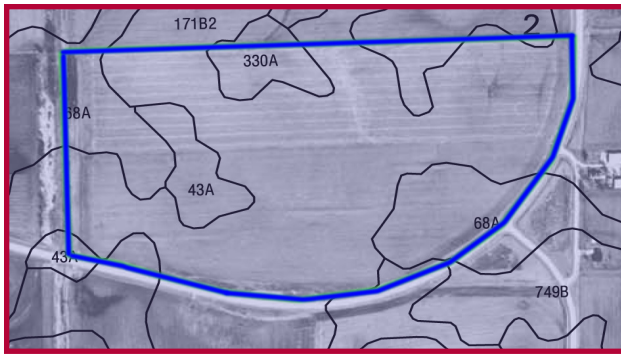

▼ Soil Productivity

Soil types and productivity ratings on the Jesse Schmid farmland (as published by the University of Illinois, Department of Agronomy in circular 811 & 1156) are as follows:

Soil #	Soil Type	Acres	% of Farm	Productivity Index (811)	Productivity Index (1156)
171	Catlin silt loam	46.48	67.8%	131.1	139.2
68	Sable silty clay loam	14.25	20.8%	143.0	155.0
43	Ipava silt loam	4.58	6.7%	142.0	160.0
330	Peotone silty clay loam	3.29	4.7%	123.0	120.0
Weighted Averages		68.60	100%	133.9	142.9
Non-tillable		0.00			
Total		68.60			

▼ Tax Information

The DeWitt County Treasurer has provided the following real estate tax information on the Jesse Schmid farmland:

Parcel ID #	Acres	2018 Assessed Value	2018 Taxes Payable in 2019	Rate Per Acre
12-02-300-006	68.60	\$28,252	\$1,685.98	\$24.57

▼ Farm Operator and Lease

This Jesse Schmid Farm is owner-operated. Corn and soybeans are the primary crops grown in the area. As soon as the 2019 harvest is complete, this land is available for any fertilizer or tillage operations that the buyer would like to perform. The lease is open for 2020.

▼ Title Insurance

The seller shall provide a title insurance policy on the amount of the purchase price for each tract of land purchased. A preliminary title commitment will be furnished upon request. Please give us a call.

▼ Terms and Conditions of Sale

The buyer(s) will be asked to sign a written contract to purchase the Jesse Schmid farmland. Heartland Ag Group Ltd. will make copies of that contract available at your request. A 10% down payment is required upon signing the contract. The balance will be due in 30 days.

Jesse Schmid is being represented by attorney Bryce A. Lynch whose contact information is as follows:

Bryce A. Lynch
216 South Center St.
Clinton, IL 61727
Phone: (217) 935-2183

▼ Disclaimer

Although the information contained in this brochure is considered to be accurate, no representation or warranties to that effect are being made. This information is subject to verification and no liability for errors or omissions is assumed.

All buyers are invited to make an inspection of the property after calling Heartland Ag Group Ltd. for an appointment.

▼ Listing Price

Heartland Ag Group Ltd. is offering the Jesse Schmid farmland for sale as follows:

68.60 acres @ \$10,700 per acre = \$734,020 in total

▼ Real Estate Broker

Real Estate Broker Heartland Ag Group Ltd. is pleased to offer this property to you. You may contact us as follows:

Dale E. Aupperle, AFM, ARA
President - Heartland Ag Group Ltd.
1401 Koester Drive
Forsyth, IL 62535

Office: (217) 876-7700

Fax: (217) 876-7724

E-mail: dale@heartlandaggroup.com

Web: www.heartlandaggroup.com



Heartland Ag Group Ltd.
1401 Koester Drive
Forsyth, IL 62535



Experience & Expertise in Farmland Marketing

▼ Real Estate Sales/Acquisitions and Auction

Heartland Ag Group Ltd sells farms for investors and farmers and acts as a broker in locating properties for prospective clients to purchase. As a joint-venture partner with Martin Auction Co., Inc. in Clinton, Illinois, Heartland Ag also offers farm real estate auction services.

▼ Rural Appraisal

Jeremy L. Crouch, is a State Certified General Appraiser with experience in farmland valuations ranging from estate appraisals to complex land divisions.

▼ Farm Management

Our team provides detailed farm management services to those who own farmland but do not operate it. Commodity marketing and soil conservation are two areas of specialization.



Dale E. Aupperle
President



Ryan E. Aupperle
Farm Manager



Jeremy L. Crouch
Rural Appraiser



Heartland Ag Group, Ltd.
1401 Koester Drive
Forsyth, IL 62535
Office: 217-876-7700
Fax: 217-876-7724
E-mail: corp@heartlandaggroup.com
Web: www.heartlandaggroup.com

- Call today for a copy of Heartland Ag Group's real estate newsletter the *Farmland Barometer*. -